

# ENCHUFE ESTANCO Y PASACABLE DECK CONNECTORS & CABLE OUTLET • BASE E PRESA STAGNE E PASSACAVI

## ENCHUFE ESTANCO DE LATÓN WATERPROOF DECK CONNECTORS IN CHROMED BRASS BASE E PRESA STAGNA IN OTTONE

Enchufes estancos para montaje en cubierta, mamparos, etc. Fabricado en latón cromado, con tapa de plástico.

Waterproof deck connectors. Manufactured in chromed brass and plastic cap, with rubber seal.

Presas estancas per il montaggio in cabina, paratia etc. In ottone cromato, con tappo in plastica.

Ref	⚡	POLOS PINS POLI	📱
GS11020	3 amp	2	1
GS11021	3 amp	3	1
GS11022	3 amp	4	1
GS11023	5 amp	2	1
GS11024	5 amp	3	1
GS11025	5 amp	4	1



## PASACABLES CABLE OUTLET PASSACAVO

Fabricado en latón cromado. Junta de goma.

Manufactured in chromed brass with rubber seal. In ottone cromato. Guarnizione in gomma.

Ref	📏	📱
GS11017	6 mm	1
GS11018	8 mm	1
GS11016	12 mm	1



## ENCHUFE ESTANCO DE NYLON WATERPROOF DECK CONNECTORS IN NYLON BASE E PRESA STAGNA IN NYLON

Enchufes estancos para montaje en cubierta, mamparos, etc. Fabricado en nylon reforzado.

Waterproof deck connectors. Manufactured in reinforced nylon.

Presas estancas per il montaggio in cabina, paratia etc. In nylon rinforzato.

Ref	⚡	POLOS PINS POLI	📱
GS11030	3 amp	2	1
GS11031	3 amp	3	1
GS11032	3 amp	4	1



Fabricado en nylon con protección contra los rayos ultravioletas y junta de goma. Puede instalarse sin desmontar los conectores.

Made in acetal with rubber seal. Waterproof co-axial installation without removing connectors avoiding poor connections.

In nylon, con protezione contro i raggi UV, e guarnizione in gomma. Si può installare senza smontare i connettori.

Ref	Ø INT (mm)	Ø EXT (mm)	📱
BS1001	17	43	1
BS1002	21	50	1
BS1003	25	63	1

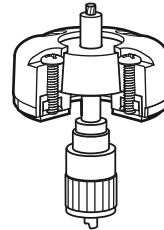

BS1001 (GPS)



BS1002 (VHF)



BS1003 (RADAR)

## PASACABLES 90° CABLE OUTLET 90° PASSACAVI 90°

Fabricado en nylon. Para salida de cables de antena o electrónica. Acepta cables simples o dobles. Espesor máximo: 50 mm.

Watertight. For antenna and electronic cables. Accepts single or double cables. Max thru-hull: 2"

In nylon. Per l'uscita dei cavi antenna o elettrici. Accetta cavo singolo o doppio. Spessore massimo: 50mm

Ref	📏	Ø (mm)	📱
THTH-CC2	☐	19 = 3/4"	1
THTH-CC1	◼	19 = 3/4"	1

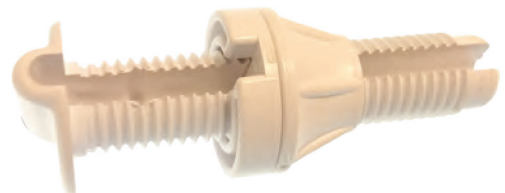

Enchufe aéreo estanco. Sumergible. Fabricado en nylon reforzado.

Waterproof connectors. Submersible. Manufactured in reinforced nylon.

Presas aéreas estancas. In nylon reforzato.

Ref	⚡	POLOS PINS POLI	📱
AM249003	85 A (14 AWG)	2	1

