

FILTERI - Filters

Oil

A/P6032

4.154M, 4.192, 4A.203, P4.192, P4.192Y, P4.203, 4.203, 4.236, 4.236M, 4A236, 4.248, 4.300, A4.300, 6.247, 6.354, 6.354M, H6.354, H6354M, T6.354, T6.354M, HT6.354, HT6..354M, 6.3544, T6.3544, ST6.3544 (4 series), 6.372, V8-510, AV-8-540., V8-605, AV8-640, TV8-640

OEM: 2654407 & 2654347

Fuel

ORB17201

4.154M, 4.192, 4A.203, P4.192, P4.192Y, P4.203, 4.203, 4.236, 4.236M, 4A236, 4.248, 4.300, A4.300, 6.247, 6.354, 6.354M, H6.354, H6354M, T6.354, T6.354M, HT6.354, HT6..354M, 6.3544, T6.3544, ST6.3544 (4 series), 6.372, V8-510, AV-8-540., V8-605, AV8-640, TV8-640
OEM:2656017

ISP. KOLEKTOR Exhaust manifold

PUMPE MORA - Pumps

BAPE-1-6354

160 HP - T6.354M Model



SHEH5

4-154 models
Ø 1" inlet
Ø 1" outlet

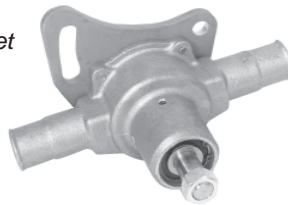

SHERPBC

6-354 models
Ø 1" NPT inlet
Ø 1" NPT outle



IMPELERI - Impellers

Reference	Ø Impeller	blades	Ø Shaft	Width
JOH09-806B	40 mm.	6	9.5 mm.	19 mm.
CEF500100GX	40 mm.	6	9.5 mm.	19 mm.
SHE10615K	65 mm.	12	16 mm.	41.4 mm.
CEF500120T	65 mm.	12	16 mm.	41.4 mm.
JOH09-1026B	51 mm.	10	12.7 mm.	22 mm.
CEF500116GX	51 mm.	10	12.7 mm.	22 mm.
JOH09-1027B	57 mm.	12	16 mm.	31.5 mm.
CEF500107T	57 mm.	12	16 mm.	31.5 mm.
SHE09959K	62 mm.	12	16 mm.	31.5 mm.
CEF500103T	62 mm.	12	16 mm.	31.5 mm.
JOH09-1028B	65 mm.	8	16 mm.	51 mm.
CEF500106GT	65 mm.	8	16 mm.	51 mm.
JOH09-819B	95 mm.	9	25.4 mm.	63 mm.
CEF500135T	95 mm.	12	25.4 mm.	63 mm.
JOH09-814B	95 mm.	12	25.4 mm.	88.9 mm.
CEF500145T	95 mm.	12	25.4 mm.	88.9 mm.

ONAN

Oil filter

PUMPE MORA - Water pumps

A/P6008

OEM: 122-0185



SHEK75B

Ø 1" inlet
Ø 1" outlet
OEM: 132-0275



SHEL10B

Ø 1 1/4" inlet
Ø 1 1/4" outlet
OEM: 1320278

IMPELERI - Impellers

Reference	Ø Impeller	blades	Ø Shaft Width	
JOH09-806B	40 mm.	6	9.5 mm.	19 mm.
CEF500100GX	40 mm.	6	9.5 mm.	19 mm.
JOH09-808B	40 mm.	6	12 mm.	19 mm.
CEF500121GX	40 mm.	6	12 mm.	19 mm.
JOH09-1027B	57 mm.	12	16 mm.	31.5 mm.
CEF500107T	57 mm.	12	16 mm.	31.5 mm.
SHE09959K	62 mm.	12	16 mm.	31.5 mm.
CEF500103T	62 mm.	12	16 mm.	31.5 mm.



KOHLER

PUMPA MORA - Water pump

SHEG907P

Ø 3/8" NPT inlet Ø 3/8" NPT outlet
OEM: 344085, 344371



IMPELERI - Impellers

Reference	Ø Impeller	blades	Ø Shaft Width	
SHE08000K	39.7 mm.	6	11.11 mm.	19 mm.
SHE09000K	62 mm.	12	15.9 mm.	22.2 mm.
CEF500165	62 mm.	12	15.9 mm.	22.2 mm.



WESTERBEKE

PUMPE MORA - Water pumps

SHER30G-1

Ø 1/2" inlet
Ø 1/2" outlet
OEM: 24102

SHER10870G

Ø 3/4" inlet
Ø 3/4" outlet
OEM: 11353



ANLASERI I ALTERNATORI Starter & alternator

ARC98175

9 tooth, 12 volt
OEM: 34552



ARC86050

12 VOLT- 50 AMP
OEM: 30594



IMPELERI - Impellers

Reference	Ø Impeller	blades	Ø Shaft Width	
SHE10077K	57 mm.	12	12.7 mm.	19.8 mm.
CEF500166	57 mm.	12	12.7 mm.	19.8 mm.
SHE09959K	62 mm.	12	16 mm.	31.5 mm.
CEF500103T	62 mm.	12	16 mm.	31.5 mm.

